

HydroWhirl® Mini



Stainless Steel Reactionary Force



DESIGN FEATURES

- Fluid-driven, self-flushing
- Durable compact design, maintenance-free
- Made from FDA-compliant, 316L material
- Suitable for food applications
- PEEK slide-bearing for greater longevity

SPRAY CHARACTERISTICS

- Vigorous spray action

Spray Angles: Complete 360° spray coverage, other spray angle patterns available upon request.

Flow Rates: 11.4 to 33.8 L/min

Max Temperature: 266° F / 130°C

Filtration: Line strainer with a mesh size of 0.3mm/50 mesh

For additional connection types contact BETE.

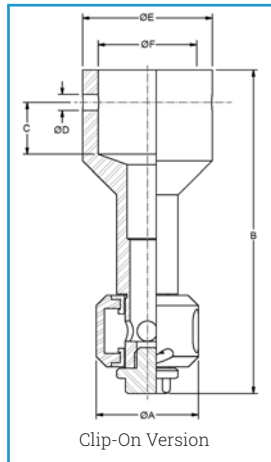
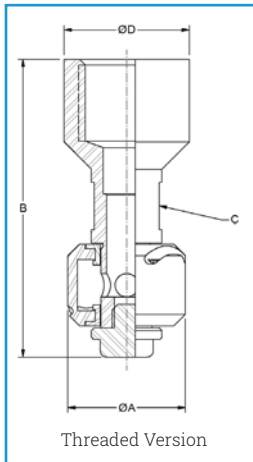

DIMENSIONS IN MILLIMETERS (CLIP-ON)

Tube Size	A	B	C	D	E	F	Weight (grams)
3/4"	20.3	63.5	10.2	2.5	25.4	20.3	31.1

DIMENSIONS IN MILLIMETERS (THREADED)

Pipe Size	A	B	C	D	Weight (grams)
3/8"	20.3	50.8	12.7	17.8	73.7

TANK CLEANING

HYDROWHIRL® MINI FLOW RATES

Materials: 316L stainless steel body: slide-bearing PEEK

Female Connection Type	Nozzle Number	Spray Angles	Flow Rate (L/min) @ Differential Pressure (bar)						Coverage Dia. @ 3 bar m
			0.5	0.7	1	2	3	4	
			bar	bar	bar	bar	bar	bar	
3/8" NPT 3/4" Tube Clip-On	HWM 7.5	360°	11.4	13.6	16.4	23.5	29.1	33.8	1.8

*Flow rates represent threaded connections with a 360° spray angle.

*Flow rates may vary for other connection types and spray angles.