

# CW

## Low Flow

### DESIGN FEATURES

- Standard 3-piece construction
- Optional 50- or 100-mesh strainer (refer to page 121 for additional information)
- Male and female connections
- Interchangeable spray tips

### SPRAY CHARACTERISTICS

- **Spray patterns:** Full Cone (F).
- For Hollow Cone (H), see page 44.
- **Spray angles:** 80° and 120°
- **Flow rates:** 0.13 to 1.54 gpm

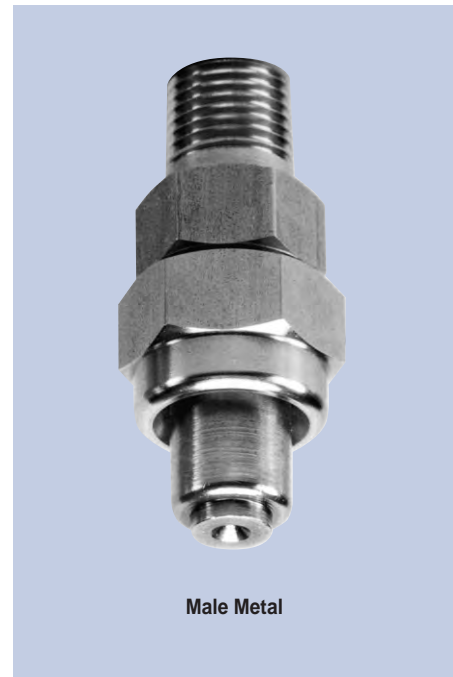

Male Metal



Full Cone 80° (F)



Hollow Cone 80° (H)

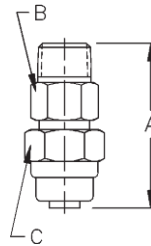

Male

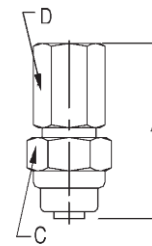

Female

Dimensions are approximate. Check with BETE for critical dimension applications.

### CW Flow Rates and Dimensions

Full Cone, 80° and 120° Spray Angles, 1/8" to 3/8" Pipe Sizes

Male or Female Pipe Size	Nozzle Number	K Factor	GALLONS PER MINUTE @ PSI											Approx. Orifice Dia. (in.)	Male or Female Pipe Size	Dimensions (in.)				Wt. (oz.) Metal
			10 PSI	20 PSI	30 PSI	40 PSI	50 PSI	60 PSI	70 PSI	80 PSI	90 PSI	100 PSI	A			B	C	D		
1/8 or 1/4 or 3/8	CW25-F	0.044	0.13	0.18	0.22	<b>0.25</b>	0.28	0.30	0.33	0.35	0.37	0.38	0.045	1/8 - 1/4	2.06	0.68	0.81	0.68	2.5	
	CW50-F	0.088	0.26	0.36	0.44	<b>0.50</b>	0.56	0.60	0.65	0.69	0.73	0.77	0.054							
	CW75-F	0.132	0.39	0.54	0.66	<b>0.75</b>	0.83	0.91	0.98	1.04	1.10	1.15	0.063	3/8	2.06	0.68	0.81	0.81		
	CW100-F	0.177	0.52	0.72	0.87	<b>1.00</b>	1.11	1.21	1.30	1.39	1.46	1.54	0.086							

Flow Rate (GPM) =  $K(PSI)^{0.47}$

Standard Materials: Brass, 303 Stainless Steel and 316 Stainless Steel.

Spray angle performance varies with pressure. Contact BETE for specific data on critical applications.

TO ORDER: specify pipe size, connection type, nozzle number, spray angle, and material.



HOLLOW CONE

# CW

## Low Flow

### DESIGN FEATURES

- Standard 3-piece construction
- Optional 50- or 100-mesh strainer (refer to page 115 for additional information)
- Male and female connections
- Interchangeable spray tips

### SPRAY CHARACTERISTICS

**Spray patterns:** Hollow Cone (H)  
 For Full Cone, see page 28  
**Spray angles:** 80° and 120°  
**Flow rates:** 0.13 to 1.54 gpm

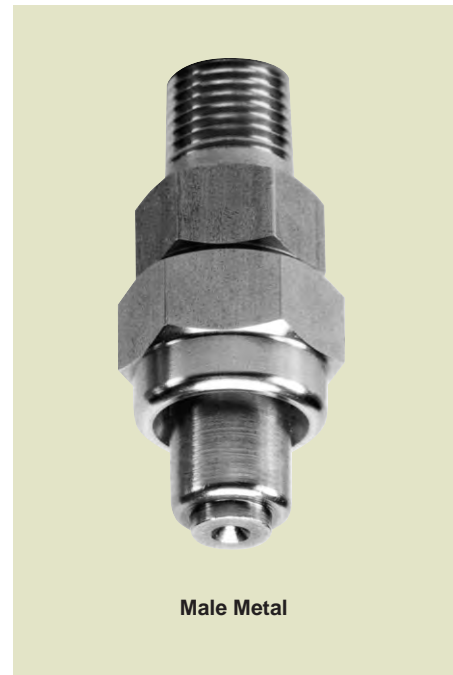

Male Metal



Full Cone 80° (F)



Hollow Cone 80° (H)

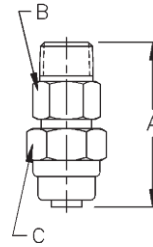

Male

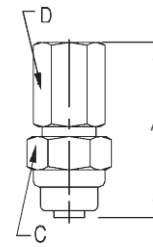

Female

Dimensions are approximate. Check with BETE for critical dimension applications.

### CW Flow Rates and Dimensions

Hollow Cone, 80° and 120° Spray Angles, 1/8" to 3/8" Pipe Sizes

Male or Female Pipe Size	Nozzle Number	K Factor	GALLONS PER MINUTE @ PSI										Approx. Orifice Dia. (in.)	Male or Female Pipe Size	Dimensions (in.)				Wt. (oz.) Metal
			10 PSI	20 PSI	30 PSI	40 PSI	50 PSI	60 PSI	70 PSI	80 PSI	90 PSI	100 PSI			A	B	C	D	
1/8 or 1/4	CW25-H	0.044	0.13	0.18	0.22	0.25	0.28	0.30	0.33	0.35	0.37	0.38	0.045	1/8 - 1/4	2.06	0.68	0.81	0.68	2.5
or	CW50-H	0.088	0.26	0.36	0.44	0.50	0.56	0.60	0.65	0.69	0.73	0.77	0.054		2.06	0.68	0.81	0.81	
or	CW75-H	0.132	0.39	0.54	0.66	0.75	0.83	0.91	0.98	1.04	1.10	1.15	0.063	3/8	2.06	0.68	0.81	0.81	
3/8	CW100-H	0.177	0.52	0.72	0.87	1.00	1.11	1.21	1.30	1.39	1.46	1.54	0.086						

Flow Rate (GPM) = K (PSI)<sup>0.47</sup>

Standard Materials: Brass, 303 Stainless Steel and 316 Stainless Steel.

Spray angle performance varies with pressure. Contact BETE for specific data on critical applications.

TO ORDER: specify pipe size, connection type, nozzle number, spray angle, and material.