

HydroWhirl® Mini



PVDF Reactionary Force



DESIGN FEATURES

- Fluid-driven, self-flushing
- Compact design, maintenance-free
- Made from FDA-compliant, PVDF material
- Corrosion-resistant
- Hydrostatic wear free slide bearing

SPRAY CHARACTERISTICS

- Vigorous spray action

Spray Angles: Complete 360° spray coverage.

Flow Rates: 3.4 to 9.0 GPM

Max Temperature: 194° F / 90°C

Filtration: Line strainer with a mesh size of 0.3mm/50 mesh

For additional connection types contact BETE.

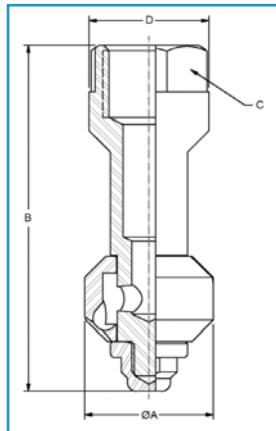

DIMENSIONS IN INCHES

Connection Size	A	B	C	Weight (oz)
1/2"	1.2	3.2	0.9	1.1

HYDROWHIRL® MINI FLOW RATES

Materials: PVDF

Female Connection Type	Nozzle Number	Spray Angles	Flow Rate (GPM) @ Differential Pressure (psi)						Coverage Dia. @ 40 psi
			10	20	30	40	50	60	
			psi	psi	psi	psi	psi	psi	Ft
1/2" NPT	HWM 7.2	360°	3.4	5.0	6.2	7.2	8.1	9.0	3.5

*Flow rates represent threaded connections with a 360° spray angle.

*Flow rates may vary for other connection types and spray angles.

HydroWhirl® Mini



Stainless Steel Reactionary Force



DESIGN FEATURES

- Fluid-driven, self-flushing
- Durable compact design, maintenance-free
- Made from FDA-compliant, 316L material
- Suitable for food applications
- PEEK slide-bearing for greater longevity

SPRAY CHARACTERISTICS

- Vigorous spray action

Spray Angles: Complete 360° spray coverage, other spray angle patterns available upon request.

Flow Rates: 3.6 to 9.1 GPM

Max Temperature: 266° F / 130°C

Filtration: Line strainer with a mesh size of 0.3mm/50 mesh

For additional connection types contact BETE.

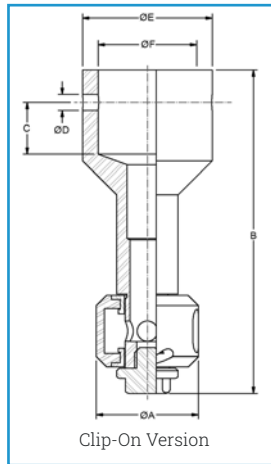
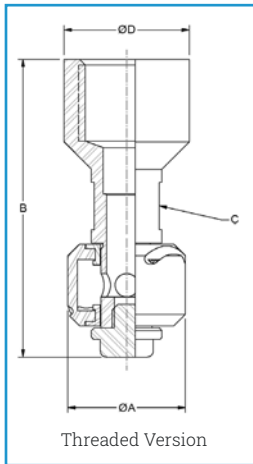

DIMENSIONS IN INCHES (CLIP-ON)

Tube Size	A	B	C	D	E	F	Weight (oz)
3/4"	0.8	2.5	0.4	0.1	1	0.8	1.8

DIMENSIONS IN INCHES (THREADED)

Pipe Size	A	B	C	D	Weight (oz)
3/8"	0.8	2.0	0.5	0.7	2.6

HYDROWHIRL® MINI FLOW RATES

Materials: 316L stainless steel body: slide-bearing PEEK

Female Connection Type	Nozzle Number	Spray Angles	Flow Rate (GPM) @ Differential Pressure (psi)						Coverage Dia. @ 40 psi
			10	20	30	40	50	60	
			psi	psi	psi	psi	psi	psi	Ft
3/8" NPT 3/4" Tube Clip-On	HWM 7.5	360°	3.6	5.1	6.3	7.5	8.3	9.1	6

*Flow rates represent threaded connections with a 360° spray angle.

*Flow rates may vary for other connection types and spray angles.

TANK CLEANING