

# HydroWhirl® Mini



PVDF Reactionary Force



## DESIGN FEATURES

- Fluid-driven, self-flushing
- Compact design, maintenance-free
- Made from FDA-compliant, PVDF material
- Corrosion-resistant
- Hydrostatic wear free slide bearing

## SPRAY CHARACTERISTICS

- Vigorous spray action

**Spray Angles:** Complete 360° spray coverage.

**Flow Rates:** 10.9 to 33.5 L/min

**Max Temperature:** 194° F / 90°C

**Filtration:** Line strainer with a mesh size of 0.3mm/50 mesh

For additional connection types contact BETE.

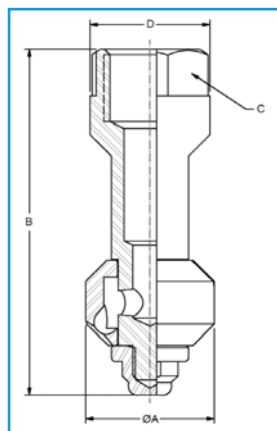

## DIMENSIONS IN MILLIMETERS

Connection Size	A	B	C	Weight (grams)
1/2"	30.5	81.3	22.9	31.1

## HYDROWHIRL® MINI FLOW RATES

Materials: PVDF

Female Connection Type	Nozzle Number	Spray Angles	Flow Rate (L/min) @ Differential Pressure (bar)						Coverage Dia. @ 3 bar m
			0.5	0.7	1	2	3	4	
			bar	bar	bar	bar	bar	bar	
1/2" NPT	HWM 7.2	360°	10.9	13.0	15.8	23.0	28.7	33.5	2.0

\*Flow rates represent threaded connections with a 360° spray angle.

\*Flow rates may vary for other connection types and spray angles.

# HydroWhirl® Mini



Stainless Steel Reactionary Force



## DESIGN FEATURES

- Fluid-driven, self-flushing
- Durable compact design, maintenance-free
- Made from FDA-compliant, 316L material
- Suitable for food applications
- PEEK slide-bearing for greater longevity

## SPRAY CHARACTERISTICS

- Vigorous spray action

**Spray Angles:** Complete 360° spray coverage, other spray angle patterns available upon request.

**Flow Rates:** 11.4 to 33.8 L/min

**Max Temperature:** 266° F / 130°C

**Filtration:** Line strainer with a mesh size of 0.3mm/50 mesh

For additional connection types contact BETE.

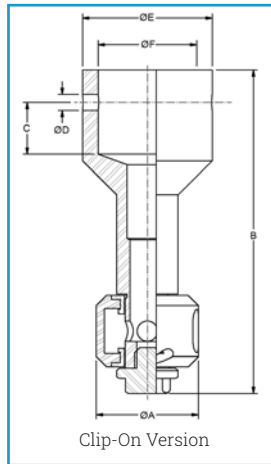
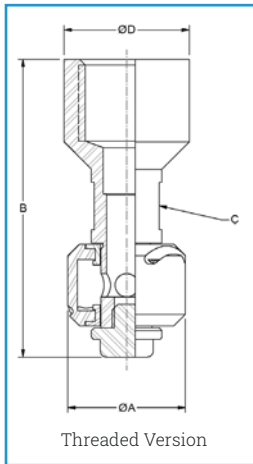

## DIMENSIONS IN MILLIMETERS (CLIP-ON)

Tube Size	A	B	C	D	E	F	Weight (grams)
3/4"	20.3	63.5	10.2	2.5	25.4	20.3	31.1

## DIMENSIONS IN MILLIMETERS (THREADED)

Pipe Size	A	B	C	D	Weight (grams)
3/8"	20.3	50.8	12.7	17.8	73.7

## HYDROWHIRL® MINI FLOW RATES

Materials: 316L stainless steel body: slide-bearing PEEK

Female Connection Type	Nozzle Number	Spray Angles	Flow Rate (L/min) @ Differential Pressure (bar)						Coverage Dia. @ 3 bar m
			0.5	0.7	1	2	3	4	
			bar	bar	bar	bar	bar	bar	
3/8" NPT 3/4" Tube Clip-On	HWM 7.5	360°	11.4	13.6	16.4	23.5	29.1	33.8	1.8

\*Flow rates represent threaded connections with a 360° spray angle.

\*Flow rates may vary for other connection types and spray angles.

TANK CLEANING