

SF

Snap Release Nozzle System

DESIGN FEATURES

- Nozzles can be quickly changed and aligned by hand without tools
- Clamp-on adapter fits any style nozzle
- Quick set-up system features special "Snap-in" tips
- Polypropylene, resistant to most acids and alkalis
- Double clamp base or adapter available for higher pressure operation



80° Full Cone

SPRAY CHARACTERISTICS

- Quick Set-up System can be provided with fan, hollow or full cone spray tips
- Full 45° alignment of spray without tools

More SF Nozzle Systems:

Hollow Cone: page 48

Flat Fan: page 68

Flow rates: 0.35 to 15.8 gpm

Spray angles:

Full Cone: 35°, 65°, 80°

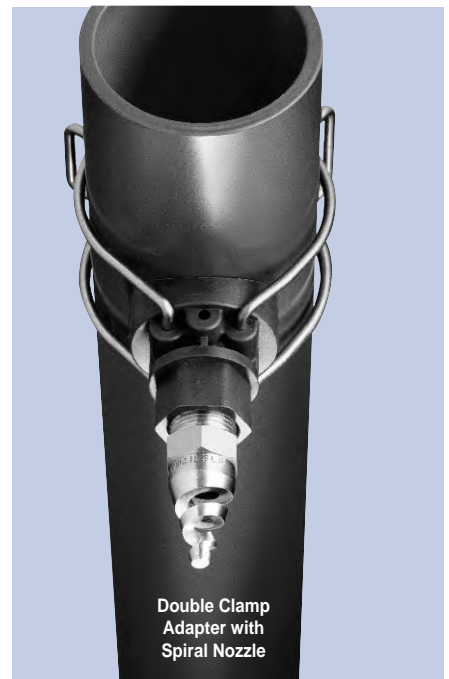
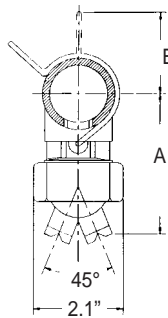

Double Clamp Adapter with Spiral Nozzle



FULL CONE

CLAMP-ON ADAPTER

- Available for 1", 1-1/4", 1-1/2" and 2" pipe.
- Available with 1/8", 1/4", 3/8", 1/2" NPT female threads; or 1/8" BSP female threads
- Available with single or double clamp.
- **TO ORDER ADAPTER Specify: Pipe Size, thread size, thread type, number of clamps, materials.**

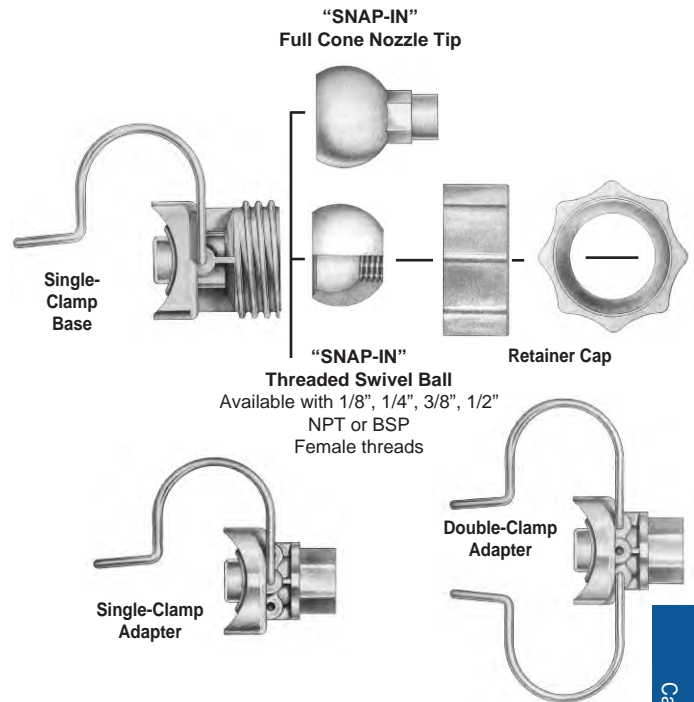

SF Flow Rates and Dimensions

SF Full Cone 35°, 65° and 80° Spray Angles 1", 1-1/4", 1-1/2" and 2" Pipe Sizes

Nozzle Number	Available Spray Angle	K Factor	GALLONS PER MINUTE @ PSI										Pipe Size	Body Color	Approx Dim. (in.)		Wt. (oz.)
			5 PSI	10 PSI	15 PSI	20 PSI	30 PSI	40 PSI	60 PSI	80 PSI	100 PSI	A			B		
SF31FC	35°	0.527	1.14	1.59	1.94	2.22	2.70	3.10	3.77	4.32	4.81	1"	blue	3.3	1.7	2.0	
SF32FC	80°	0.545	1.18	1.64	2.00	2.29	2.79	3.20	3.89	4.46	4.97	1-1/4"	red	3.4	1.9	2.2	
SF102FC	65°	1.736	3.76	5.24	6.37	7.31	8.88	10.2	12.4	14.2	15.8	1-1/2"	purple	3.6	2.0	2.2	
												2"	green	3.7	2.2	2.2	

$$\text{Flow Rate (GPM)} = K(\text{PSI})^{0.48}$$

Standard Materials: Polypropylene, 302 Stainless Steel clamp, EPDM seal.

Optional Materials: Viton seal.

NOTE: Drill 21/32" hole in pipe to install SF.

NOTE: Maximum recommended working pressures for SF assemblies: with single clamp, 70 psi for 1" pipe; 50 psi for 1-1/4" and 1-1/2" pipe; and 35 psi for 2" pipe; with double clamp up to 150 psi.