

LEM

Tank Washing Nozzle

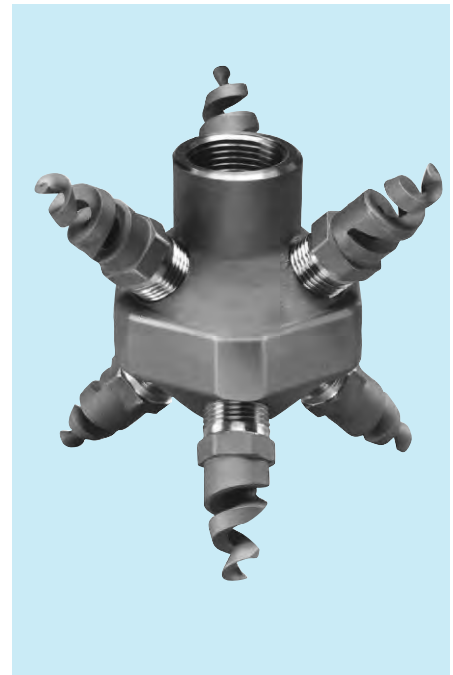

DESIGN FEATURES

- Each nozzle in the stationary cluster is a BETE clog-resistant spiral nozzle of the TF Series
- Can be supplied with various other BETE nozzles for any desired application
- Female connection

SPRAY CHARACTERISTICS

- Spherical omnidirectional coverage
 - Six nozzles arranged in cluster to project spray in all directions
- Flow rates:** 4.2 to 157 gpm (special flow rates available; special tips upon request)

TANK WASHING

LEM Coverage Chart

When Spraying at 40 - 50 PSI

Female Pipe Size	Nozzle Number	Scrubbing Diameter (ft.)	Rinsing Diameter (ft.)
3/4	LEM6	1.5	3.0
	LEM8	3.0	6.0
	LEM10	4.5	9.0
1	LEM12	6.5	13.0
	LEM14	6.8	13.5
	LEM16	7.2	14.5
	LEM20	8.0	16.0

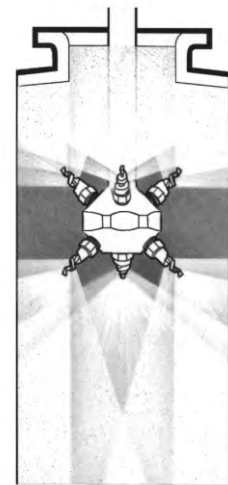
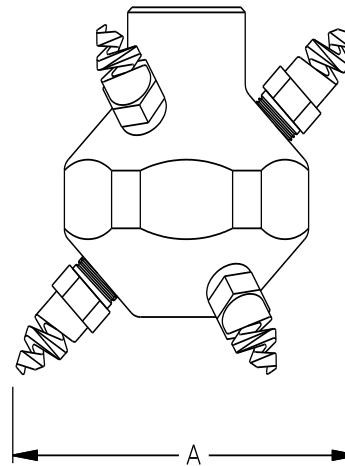

Typical LEM installation

Dimensions are approximate. Check with BETE for critical dimension applications.

LEM Flow Rates and Dimensions

Spherical, 360° Spray Angle, 3/4" and 1" Pipe Sizes

Female Pipe Size	Nozzle Number	K Factor	GALLONS PER MINUTE @ PSI							Minimum Entrance Open. (in.) A	Weight	
			10 PSI	20 PSI	30 PSI	40 PSI	60 PSI	80 PSI	100 PSI		(lbs.) Metal	(oz.) Plas.
3/4	LEM6	1.33	4.20	5.94	7.27	8.40	10.3	11.9	13.3	4.50	2.25	6.00
	LEM8	2.53	8.00	11.3	13.9	16.0	19.6	22.6	25.3			
	LEM10	3.95	12.5	17.7	21.7	25.0	30.6	35.4	39.5			
1	LEM12	5.69	18.0	25.5	31.2	36.0	44.1	50.9	56.9	5.25	4.13	11.0
	LEM14	7.68	24.3	34.4	42.1	48.6	59.5	68.7	76.8			
	LEM16	9.96	31.5	44.5	54.6	63.0	77.2	89.1	99.6			
	LEM20	15.7	49.5	70.0	85.7	99.0	121	140	157			

Flow Rate (GPM) = $K\sqrt{PSI}$

Standard Materials: Brass, 316 Stainless Steel, PVC and PTFE.

Spray angle performance varies with pressure. Contact BETE for specific data on critical applications.

TO ORDER: specify pipe size, connection type, nozzle number, spray angle, and material.